

Yoswit Smart Double Pole Switch Datasheet

Model: YO812c (R2W)

Revised: 01-12-2024



Control High-Power Appliances with Ease

Yoswit Smart Double Pole Switch is designed for high-power household appliances, providing enhanced safety protection for your devices and electrical circuits. Featuring electricity usage monitoring for appliances, it promotes energy efficiency through low power consumption. The built-in timer allows convenient scheduling and control of your appliances for enhanced convenience. It offers compatibility with various third-party smart home systems and integrates smoothly with smart speakers. With its built-in WiFi serving as a central gateway, it seamlessly connects with other Yoswit products, empowering remote management of both Yoswit products and household appliances through our Yoswit App, simplifying the interaction with your smart devices.

Connection :

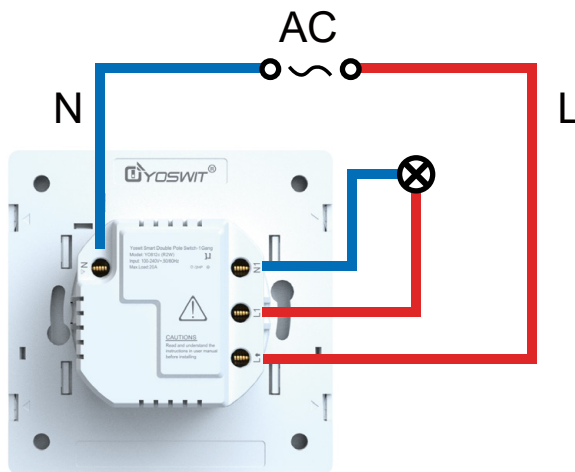

Key Features and Benefits

- Ideal for high- power appliances
- Electricity usage monitoring
- Built-in timer for automation
- Central hub for smart devices
- Bluetooth Mesh & Wifi enhance connectivity and extend range
- Third-party smart home systems compatibility
- OTA remote upgrades
- 2-year limited warranty

Various Customized Products

We offer a comprehensive selection of smart home products that are seamlessly adapted to the usage standards and various socket types in different countries, ensuring a smooth installation process for all users. With extensive compatibility, our products enable you to control a diverse range of household appliances, including lighting, air conditioning, and TV.



Light Switch



Dimmer Switch



2 Way Switch



Double Pole Switch



Gate Controlled Switch



Hidden Controlled Switch



Outlet



Roller



Curtain



Remote Control



Thermostat

Yoswit App

You can download our app to implement the following functions via Bluetooth and WiFi to control the Yoswit switches.

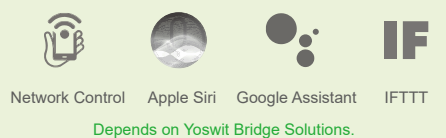
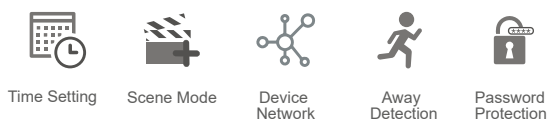

Depends on Yoswit Bridge Solutions.



Product Specifications

Color Options:

*You can also customize the colors

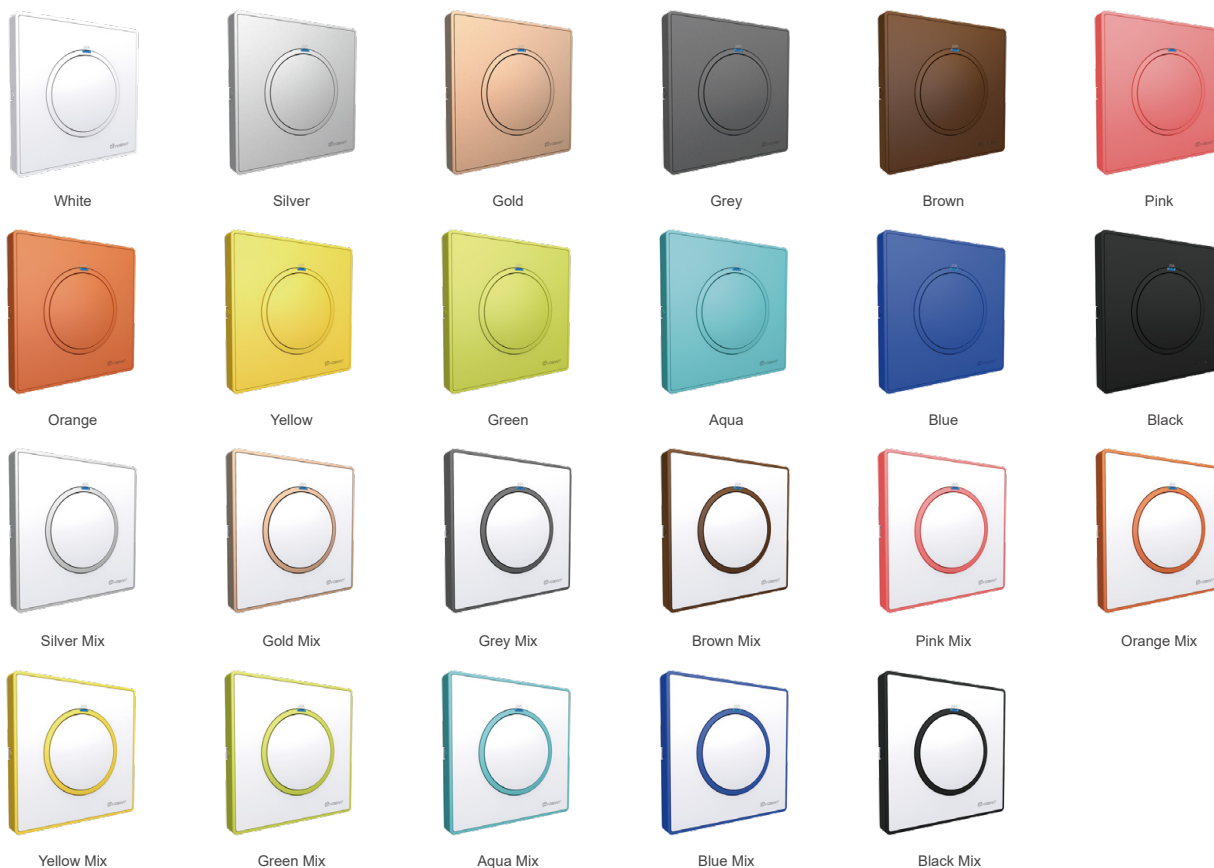

Specifications:

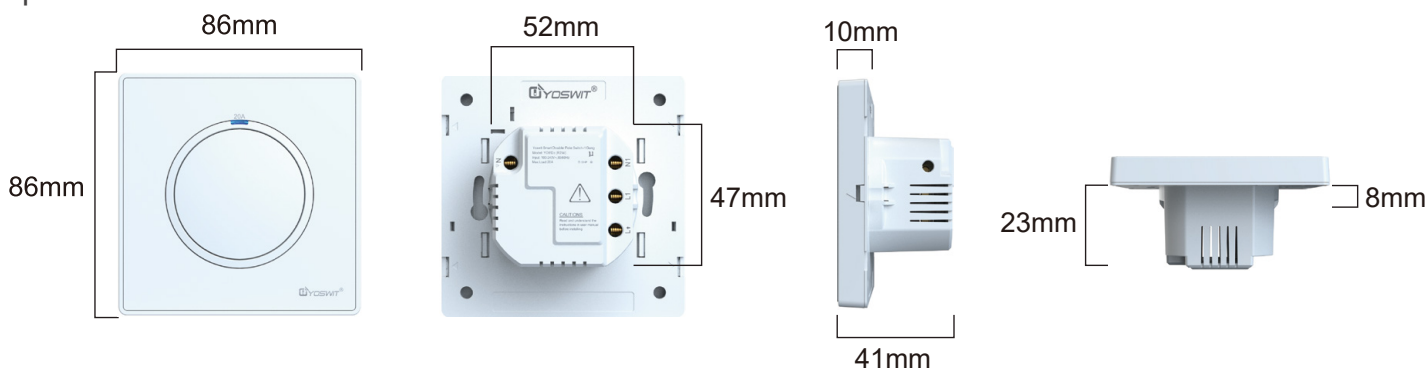

Electrical

Operation Power	100-240V AC (50/60Hz)
Power Consumption	<1W
Max. Load	8A / 1HP
Power Measurement Accuracy	±3%

Wireless

Frequency	2.4GHz
Connection	Wifi 2.4G / BLE 4.2
Range	Open Area: >50m / Interior: 3-20m

General Specifications

Product Name	Yoswit Smart Double Pole Switch
Model	YO812c (R2W)
Socket Type	Socket 55
EAN / UPC	EAN: 0765756498548 / UPC: 765756498548
Revision	V7.0
Compliance	CE, FCC, RoHS
Manufacturer	Designed by Yoswit in Hong Kong, China / Assembled in Guangdong, China
Warranty	Two Year Limited Warranty (*Details available on the Product Warranty and Limitations of this datasheet)

Mechanical

Operating Temperature	-10°C to 40°C
Operating Humidity	0-95% RH, Non-Condensing
Operating Environment	Interior
Operation	APP / Manual
Ingress Protection (IP)	20

Product Package

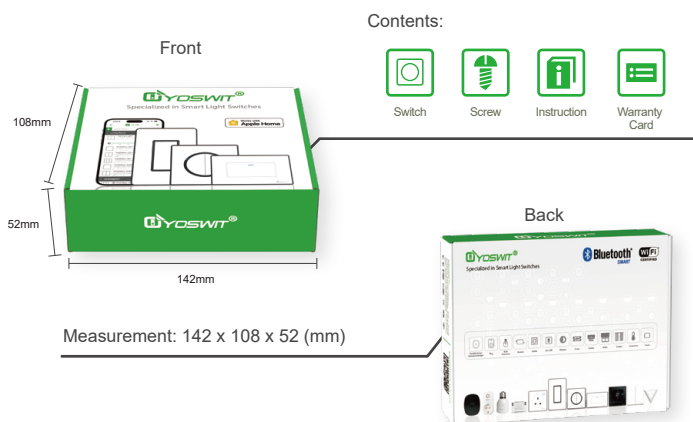

Outer Box



Quantity Per Box: 40 Pack / Box
Measurement: 58 x 31 x 23.5 (cm)

Product Warranty and Limitations

Yoswit brand products guarantee for a period of 2 years warranty from the date of purchase. During the warranty period and in the event that a defective product is identified (non-human factors), Yoswit will provide free maintenance. Damage beyond the warranty period or caused by improper use is not covered within the warranty, Yoswit will not bear any responsibility for repair, and will still provide users with a lifelong maintenance of paid services. If the products need to be repaired or returned to our company, an appropriate fee should be charged based on specific situation to cover the cost of replacement. Regardless of the warranty status, all shipping costs are borne by users.

LINCOGN TECHNOLOGY CO. LIMITED

Address: Room 202, 2/F, Building No. 19 West Science and Technology Avenue, Science Park, Shatin, N.T., Hong Kong
info@yoswit.com | Tel: (852) 3996 9396 | Fax: (852) 3119 8778 | www.yoswit.com